

heads of all Corcove Windows including
arches over tracery windows (F. 5)

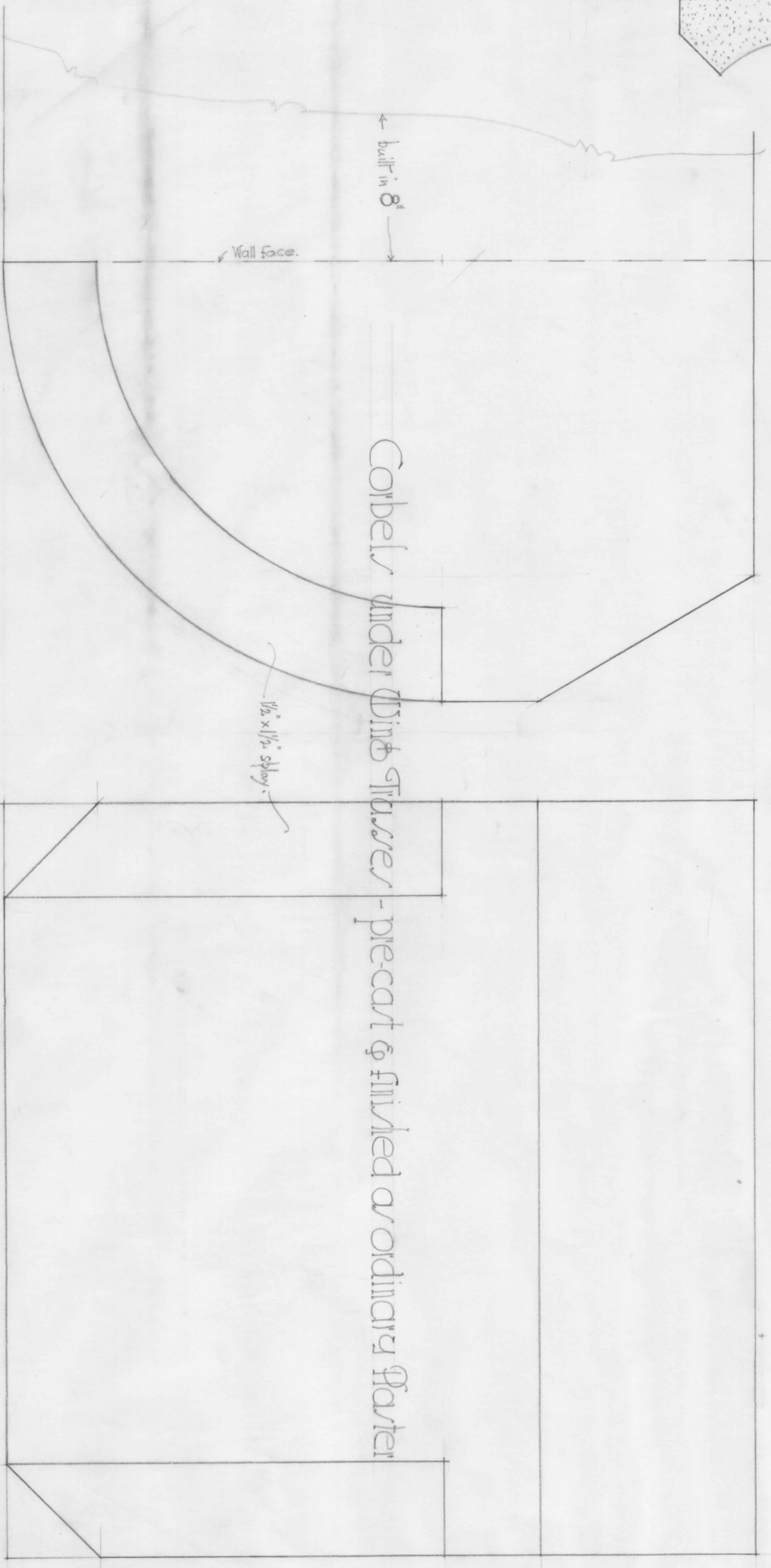

V.B.C. The Library
F.S. Plaster detail.
D. 1901
Shed & Stomper
Apr. 1. B. A.
November 20.

Corbel under Window Trusses - pre-cast & finished or ordinary Plaster



built in 8'
Wall face.

1/2" x 1/2" splay