

COLLEGE LIBRARY NO. 1

COLLEGE LIBRARY NO. 2

DIVISIONAL READING ROOM

SPECIAL COLLECTIONS R.R. & CARRELL'S

REFLECTED CEILING PLANS

SCALE 1/16" = 1'-0"

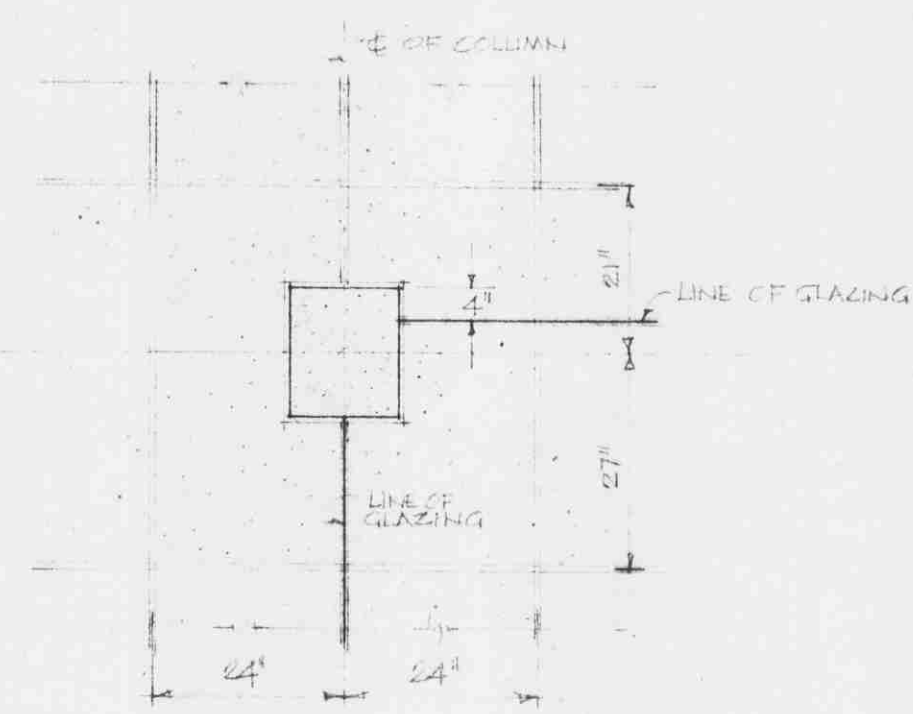
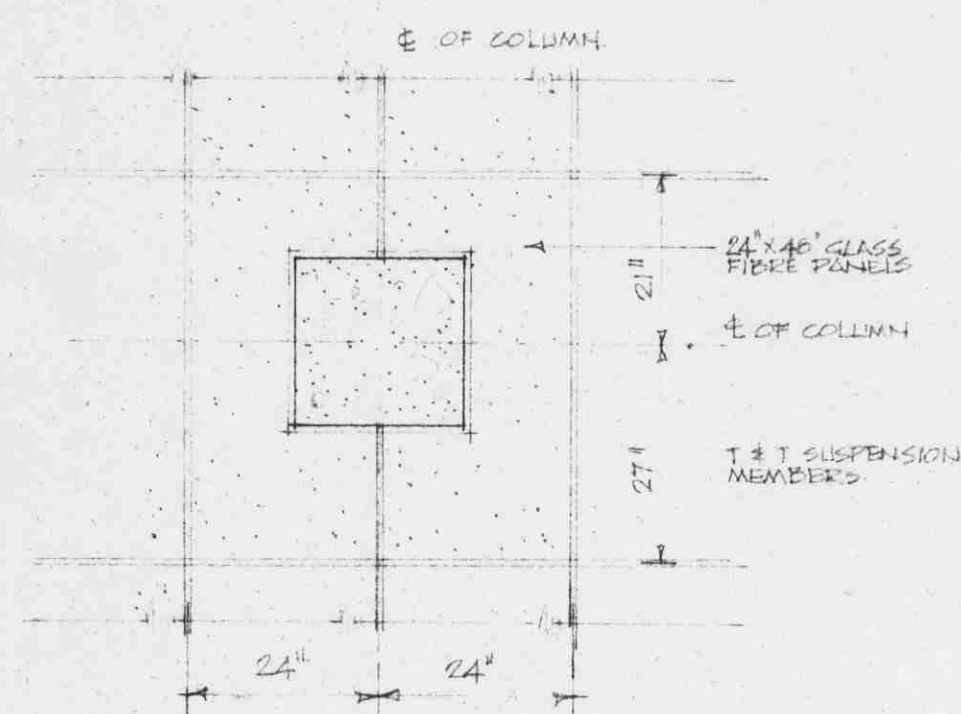

DETAIL A

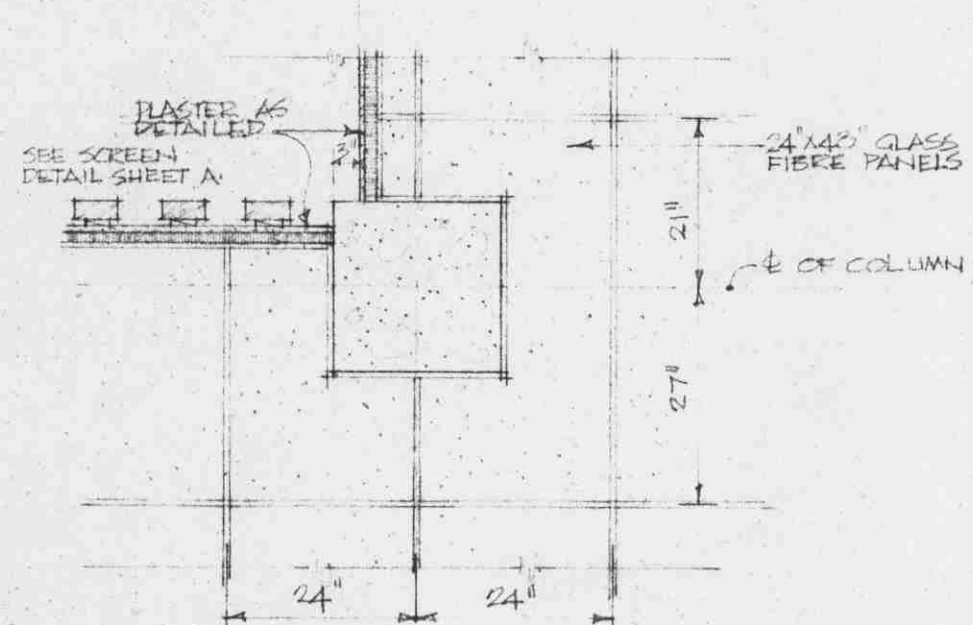

DETAIL B

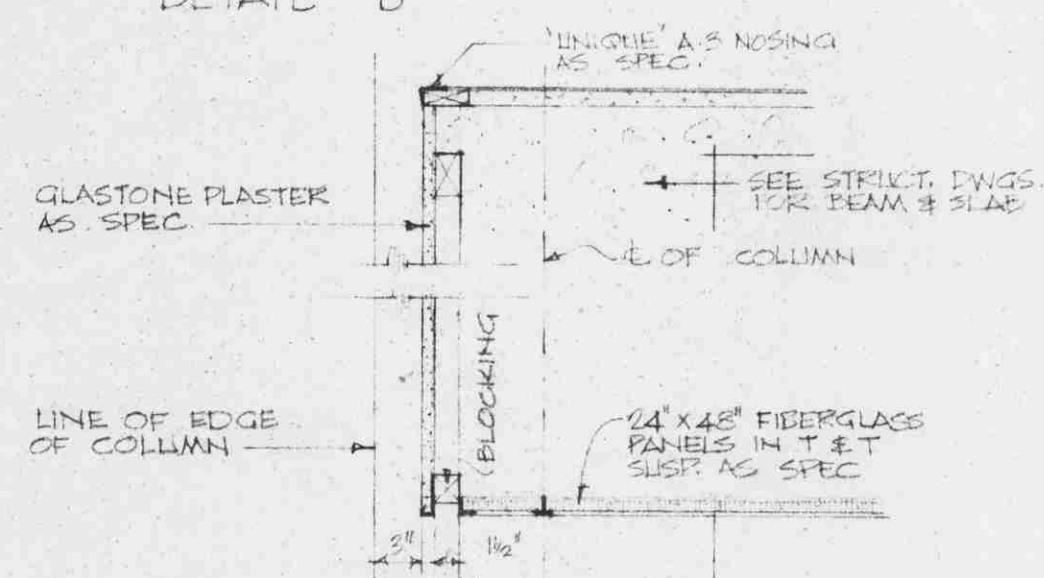

DETAIL C

No.	DATE	REVISION

THOMPSON, BERWICK & PRATT
ARCHITECTS
1555 ROBSON ST. VANCOUVER 5, B. C.

ADDITIONS TO THE LIBRARY
UNIVERSITY OF BRITISH COLUMBIA
CEILING PLANS

SHEET No.

A-13
OF

DRAWN: R.B.A. CHECKED: SCALE AS SHOWN DATE: MAY